

**IMPORTANT** - READ CAREFULLY BEFORE INSTALLING FIXTURE. RETAIN THESE INSTRUCTIONS FOR FUTURE REFERENCE.  
THIS PRODUCT MUST BE INSTALLED IN ACCORDANCE WITH THE NATIONAL ELECTRICAL CODE AND ALL APPLICABLE LOCAL CODES, BY A PERSON FAMILIAR WITH THE CONSTRUCTION AND OPERATION OF THE PRODUCT, AND THE HAZARDS INVOLVED. PROPER GROUNDING IS REQUIRED FOR SAFETY.

**INSTALLING PROJECTOR ON ONE CIRCUIT TRACK WITH HALO ADAPTOR (1790S1)  
FOR USE WITH SISTEMALUX S1, YA-I ENTERPRISE'S B95 OR COOPER LIGHTING'S L641, L642, L643 SERIES.  
TRACK SYSTEM ONLY (120V)**

- A- PULL THE ADAPTOR HOUSING DOWN TO INSERT IN THE TRACK FOLLOWING INITIAL POSITION SHOWN BELOW.  
B- PUSH THE PROJECTOR INTO TRACK AND ROTATE THE TRACK ADAPTOR A QUARTER TURN IN THE PROPER DIRECTION IN ORDER TO ALLOW ELECTRICAL BOUNDING. MAKE SURE THE ADAPTOR IS LOCKED IN PLACE, FOLLOWING FINAL POSITION SHOWN BELOW.

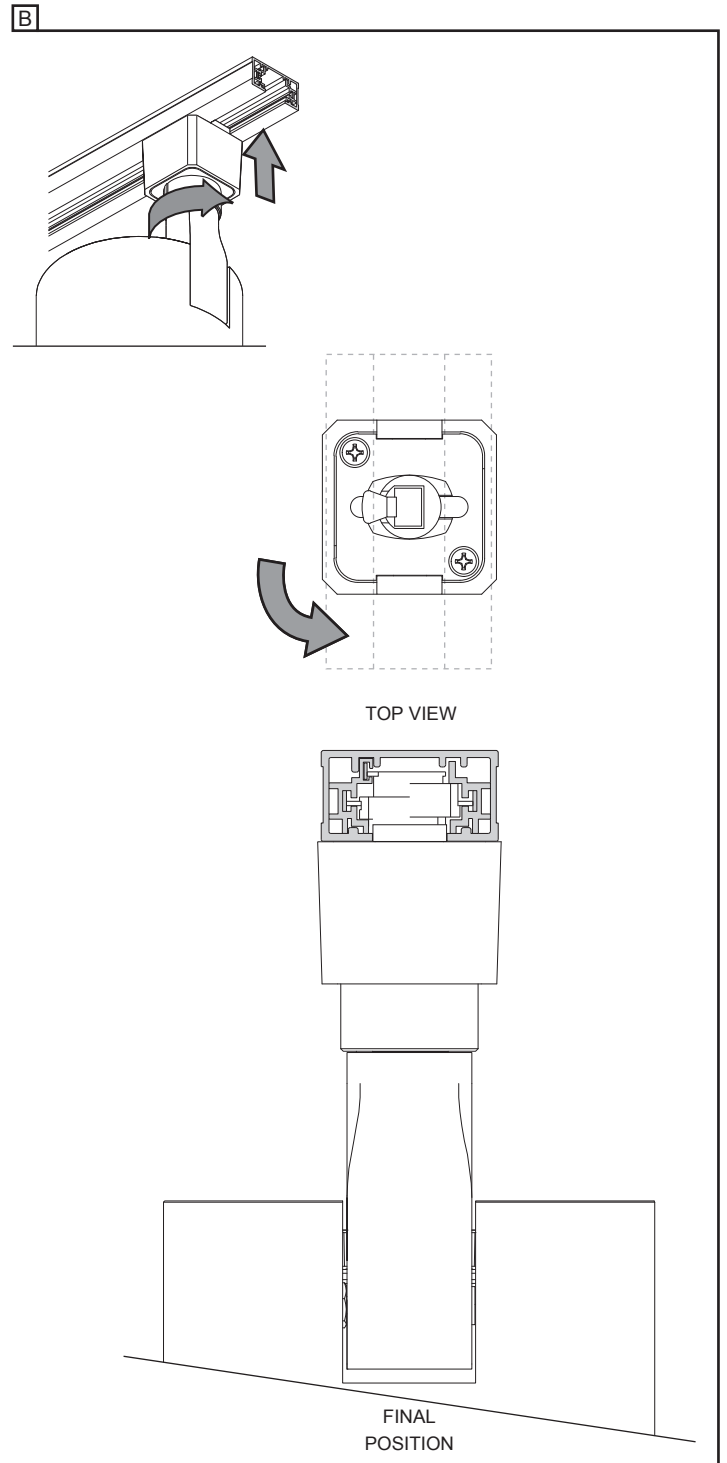
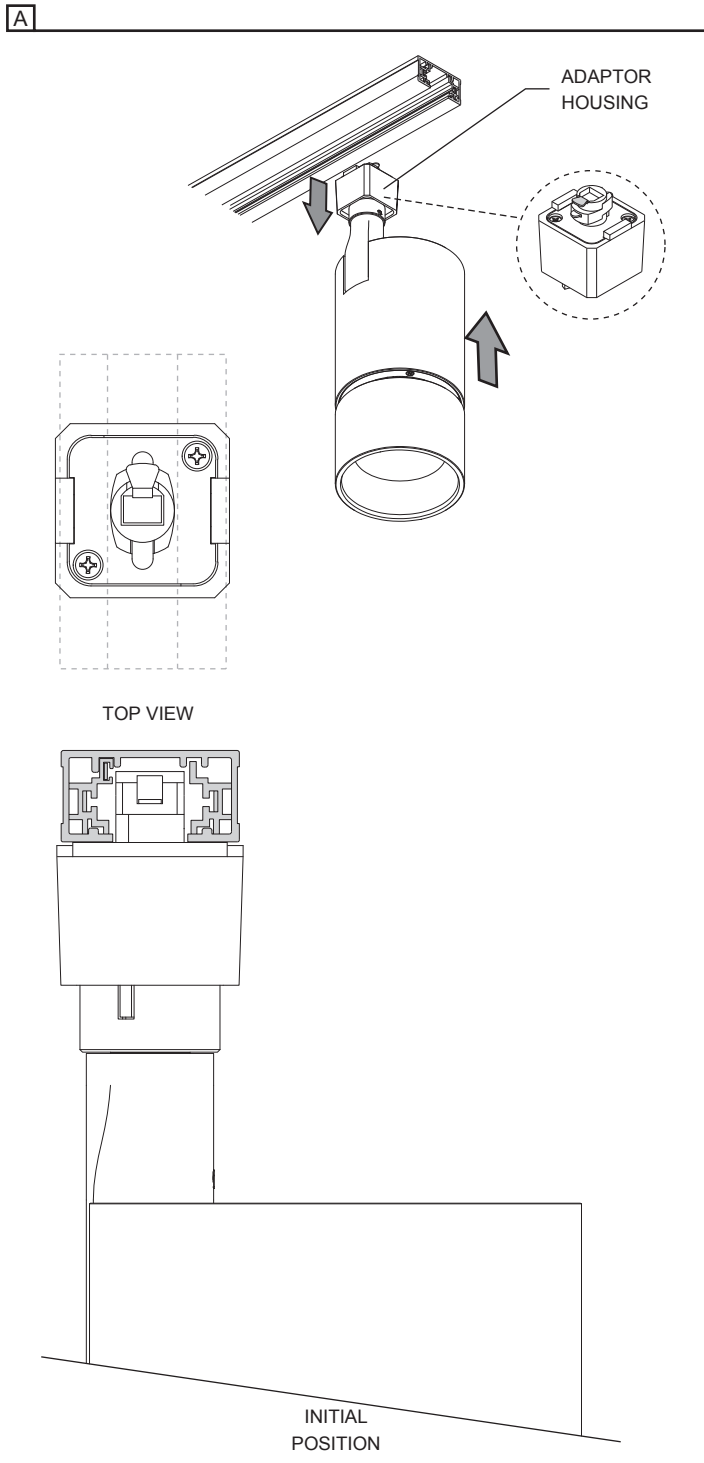

## REMOVING PROJECTOR FROM ONE CIRCUIT TRACK (1790S1)

A- PULL DOWN THE TRACK ADAPTOR HOUSING TO UNLOCK IT FROM THE TRACK SLOT.

B- HOLDING THE TRACK ADAPTOR HOUSING DOWN, ROTATE A QUARTER TURN IN ANY DIRECTION AND PULL DOWN THE PROJECTOR TO REMOVE IT FROM THE TRACK.

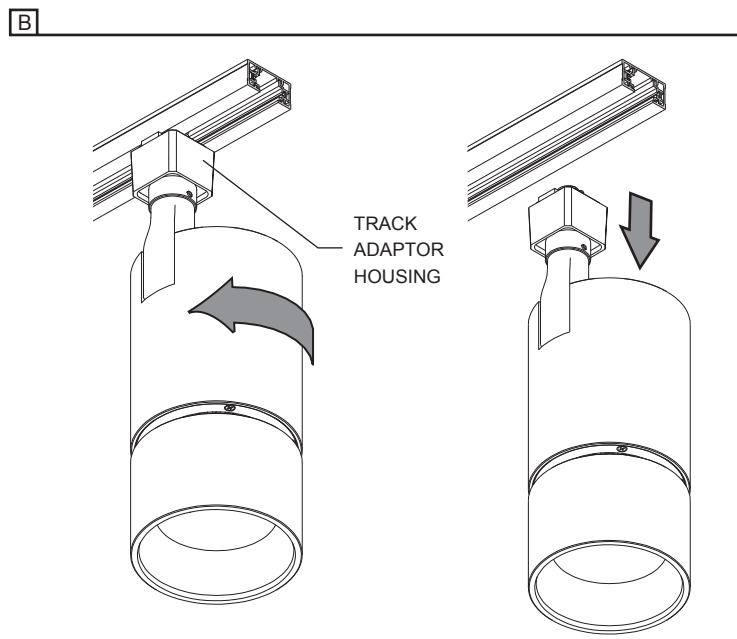
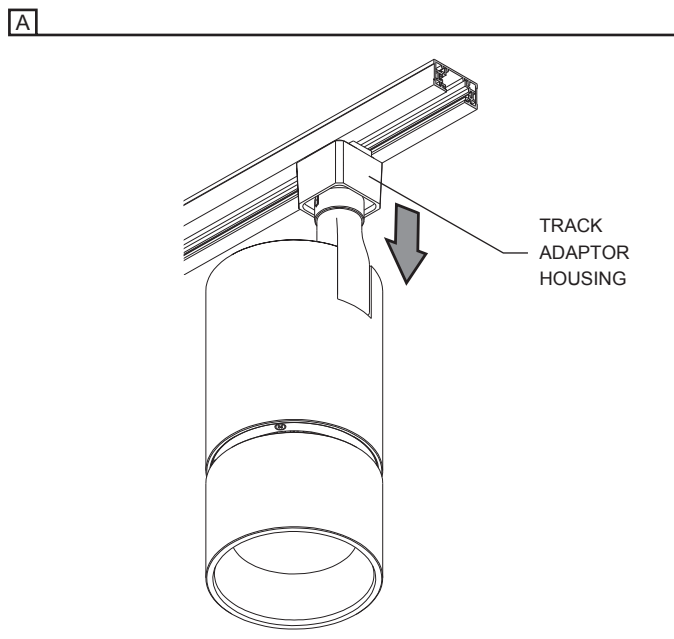

## PAN ANGLE POSITION (1790S1)

A- LOOSEN THE PAN ADJUSTMENT LOCKING SCREW.

B- SET THE DESIRED PAN POSITION (MAXIMUM OF 330° AXIAL ROTATION) AND LOCK THE POSITION WITH THE PAN ADJUSTMENT LOCKING SCREW, USING A FLATHEAD SCREWDRIVER.

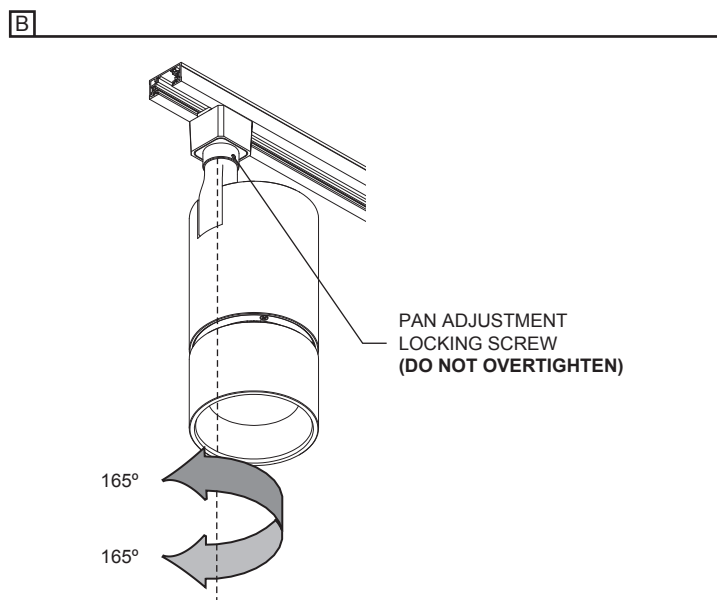
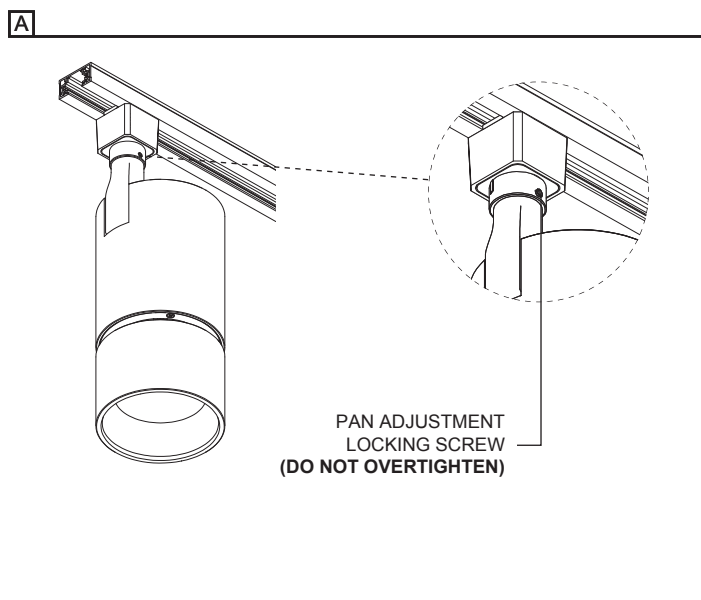

## TILT ANGLE POSITION (1790S1)

A- LOOSEN THE TILT ADJUSTMENT LOCKING SCREW.

B- SET THE DESIRED TILT POSITION (MAXIMUM OF 90° AXIAL ROTATION) AND LOCK THE POSITION WITH THE TILT ADJUSTMENT LOCKING SCREW, USING A FLATHEAD SCREWDRIVER.

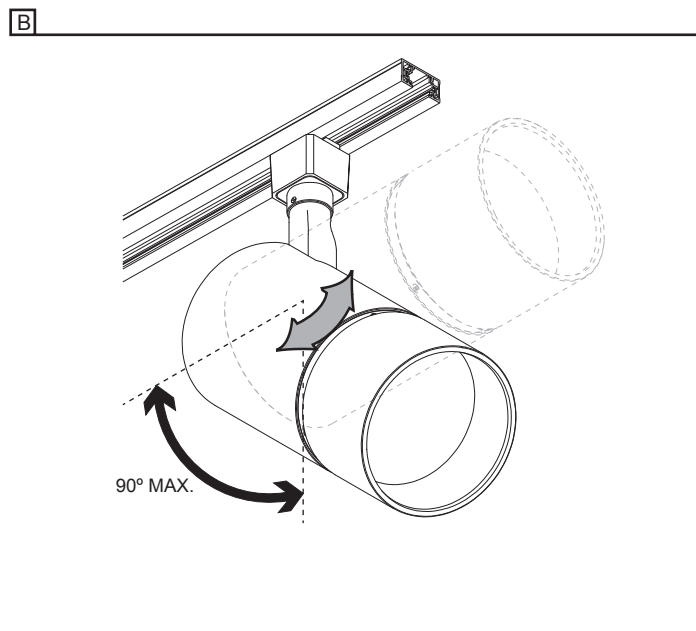
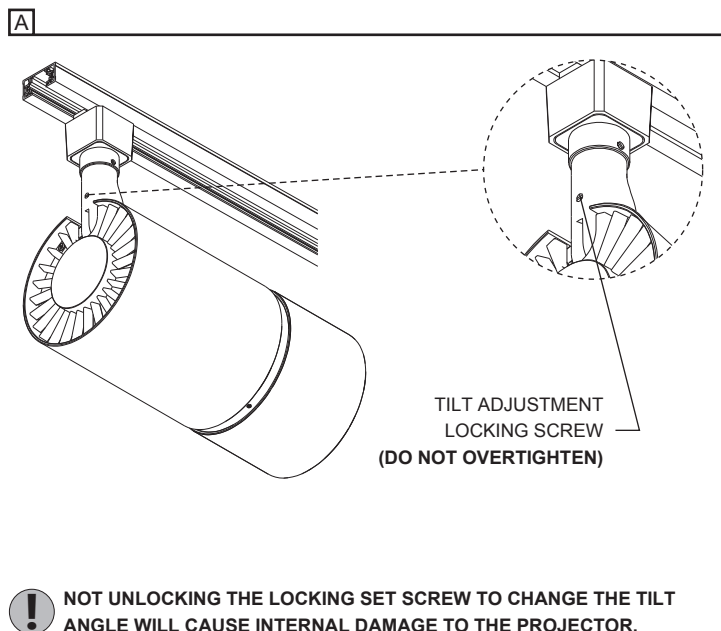

## REPLACING OPTIC

A- UNSCREW THE OPTIC HOLDER TO ACCESS THE REFLECTOR.

B- REPLACE THE REFLECTOR AND RE-INSTALL THE OPTIC HOLDER BACK IN PLACE.

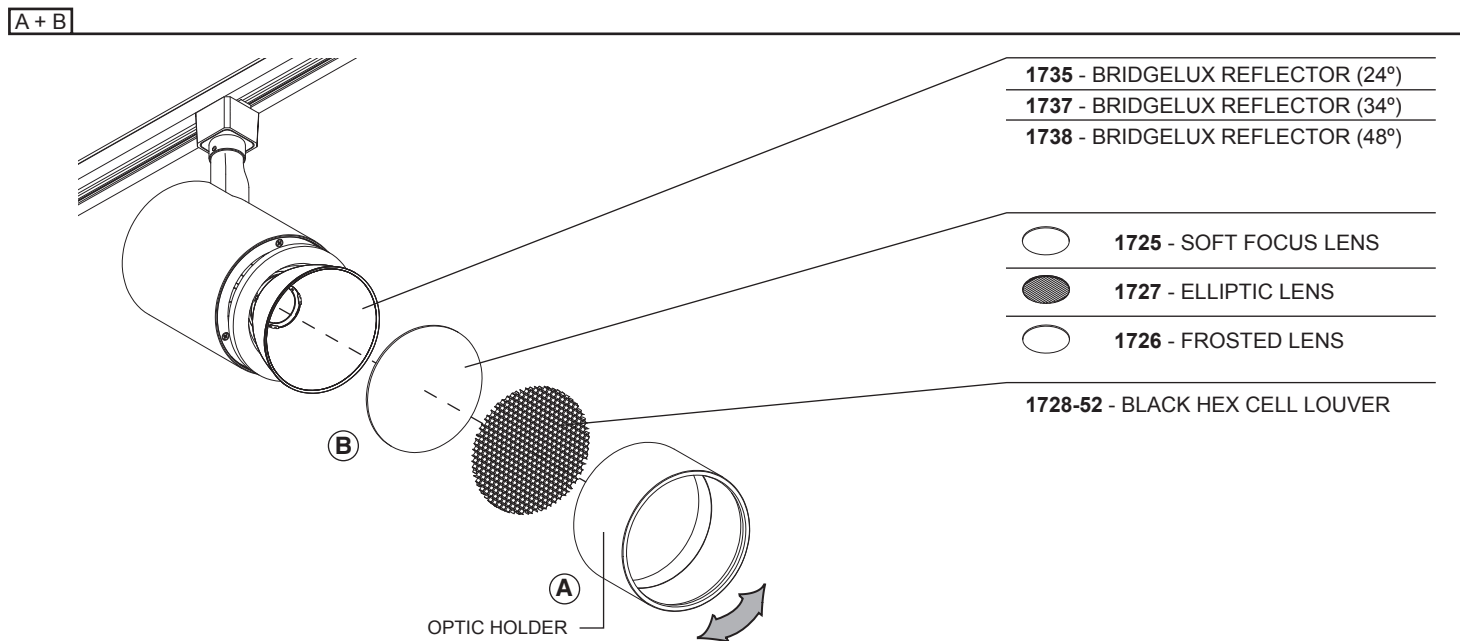

## ACCESSORIES

- A- UNSCREW THE OPTIC HOLDER  
B- PLACE ACCESSORY BETWEEN THE OPTIC HOLDER AND THE ACCESSORY HOLDER  
C- RE-INSTALL THE OPTIC HOLDER BACK IN PLACE.

A + B + C

